

SECOND DISTRICT

FEDERATED GARDEN CLUBS OF NEW YORK STATE

The first garden club in New York, the Flushing Garden Club, was organized in 1914 by Mrs. John Walton Paris. There were ten clubs by 1922 and by March of 1924, the Federation of Long Island Clubs became a vision realized. Twelve clubs were represented and twelve more joined within three months; all were considered Charter Members and of the original twenty-four clubs, thirteen are still meeting today. The first Annual Meeting was held in 1925 at the Roosevelt Hotel in New York City and the federation continued to grow throughout the state. At this time, the Long Island Federation merged with the state and became known as Second District. Only four years later in 1929, the Federated Garden Clubs of New York State became a charter member of National Council of State Garden Clubs, with some of the same aims and purposes sponsored today: conserving and protecting wildflowers; encouraging civic plantings and preserving scenic and historic locations; stressing planting of trees; and cooperating with plant societies.

Clubs in Second District, which includes Queens, Nassau and Suffolk Counties, now number 39. Second District has the most clubs in New York State. The total membership numbers almost 2,000.

Two district meetings are held each year for members, and workshops on various phases of garden club work are held periodically. Flower Show Schools, sponsored by the state but planned and operated by a district chairman, have been held in the district since 1951 for garden club members who wish to become Nationally Accredited Judges and for members and nonmembers who wish to further their knowledge in horticulture, floral design and flower show practice.

The first district newsletter was published in 1928. Since 1955, it has been called "The Long Island Gardener." Published four times a year, it gives members complete coverage of district and club activities.

Flower shows have been held by member clubs since the thirties. District shows are held and have received many State and National awards.

The aims of the Second District continue to be: the conservation of our national resources, beautification and preservation of communities, the organization of youth clubs, the sponsorship of therapy programs, and the education of the public.

A Social Whirl

An NGC Standard Flower Show
presented by

SECOND DISTRICT
FGCNYS

BRECKNOCK HALL

1500 Brecknock Road
Greenport, NY 11944
631-593-8200

SATURDAY
SEPTEMBER 21, 2019
9AM-4PM

Second District, FGCNYS which has 38 member clubs.
Second District is a member of National Garden Clubs, Inc.,
Central Atlantic Region of State Garden Clubs, Inc., and
Federated Garden Clubs of New York State, Inc.

The show is free and open to the public.

TABLE OF CONTENTS

Title Page
 Table of Contents
 Flower Show Committee ChairmenPage 1
 General RulesPages 2-3
 National Garden Clubs, Inc. Standard System of Awarding.....Page 3
 National Garden Clubs, Inc. Top Exhibitor AwardsPages 4-6
 NGC Non-Top Awards, Scale of Points, & District TrophiesPage 7
 Division I, Design
 Design RulesPage 8
 Design Scale of PointsPage 9
 Design Sections A-C, classes 1-9.....Pages 9-10
 Division II, Horticulture
 Horticulture RulesPages 11-12
 Horticulture Scales of Points.....Pages 12-13
 Horticulture Sections A-H, classes 1-28Pages 14-16
 Division III, Education
 Educational RulesPage 17
 Educational Scale of Points.....Page 18
 Educational Exhibits Section A, class 1, exhibits 1-3Page 18
 Division IV, Botanical Arts Botanical Design
 Botanical Design RulesPage 19
 Botanical Design Exhibits, Section A, classes 1-3.....Page 20
 Division IV, Botanical Arts Artistic Crafts
 Artistic Crafts RulesPage 21
 Artistic Crafts Scale of PointsPage 21
 Artistic Crafts Exhibits, Section B, classes 1-3Page 22
 Division IV, Botanical Arts Photography
 Photography RulesPage 23
 Photography Scale of PointsPage 24
 Photography Exhibits, Section C, classes 1-3Page 24
 Floor Plan of Brecknock HallPage 25
 History of Second District, FGCNYSPage 26

FLOOR PLAN BRECKNOCK HALL NOT TO SCALE

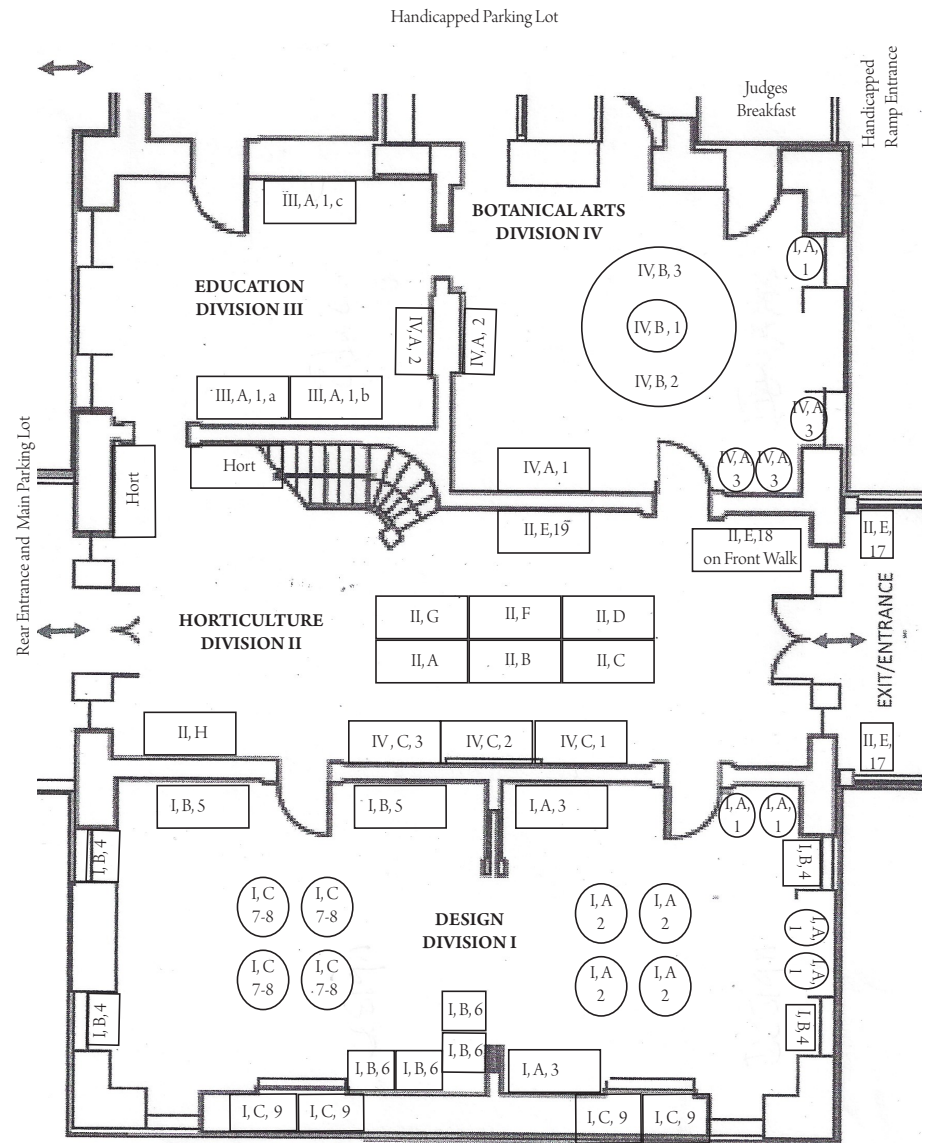

PHOTOGRAPHY SCALE OF POINTS

Criteria	Value (points)
Conformance	5
Interpretation of Class Title	10
Composition	25
Artistry/Creativity	25
Technical Achievement	25
Distinction	10
Total Score	100

DIVISION IV + BOTANICAL ARTS

SECTIONS AND CLASSES “BELLS AND WHISTLES”

SECTION C. PHOTOGRAPHY

“MIGHTY ELEMENTS”

Eligible for Botanical Arts Photography Award.

Advance entry required. See Photography Rules for matting. Four Entries in each class.

Class 1. “Earth”

A single, 8”x 10” image.

Class 2. “Wind”

A single 8”x10” color image.

Class 3. “Fire”

A single, 8”x 10” color image.

COMMITTEE CHAIRMEN

District Director	Kim Thomson	631-271-0028
Flower Show General Chairman	Bernadette Pepin	631-333-2405
Schedule	Kim Thomson	631-271-0028
Staging & Properties	Laura McLaughlin	631-666-0029
Entries	Gail Berti	631-271-7383
Design Division I (Advance Entries, Classification, Consultant & Placement)	Gail Berti	631-271-7383
Horticulture Division II		
Advance Entries	Denise D’Onofrio-Zizzo	631-757-3710
Entries	Sue Avery	
Consultants & Classification	Denise D’Onofrio-Zizzo	631-757-3710
	Kim Thomson	631-271-0028
Placement	Gloria Grocock	631 734 6714
	Nancy Irace	631-653-6955
Education Division III		
(Advance Entries, Classification, Consultant & Placement)	Lovejoy Duryea	917-734-9595
Botanical Arts Division IV		
Artistic Crafts (Advance Entries, Classification, Consultant & Placement)	Jenny Holmes	631-549-3635
Botanical Design (Advance Entries, Classification, Consultant & Placement)	Sue Boudreau	631-666-9517
Photography (Advance Entries, Classification, & Placement)	Hilde Peters	631-765-1337
Photography Consultant	Bobby Duryea	631-325-3438
Judges	Eileen DeRicco	631-878-1481
Judges’ Luncheon	Bernadette Pepin	631-333-2405
Clerks	Cafti Walsh	631-862-9451
Awards	Gail Berti	631-271-7383
Publicity	Lynn Pezold	631-271-8817
Hospitality	Elizabeth Walsh	631-479-7776
	Jenny Holmes	631-549-3635
Book of Evidence	Bernadette Pepin	631-333-2405
Bus Coordinator	Terry Sajewski	631-547-8047
Fundraising	Sue Boudreau	631-666-9517
	Bernadette Pepin	631-333-2405
Tallies	Kim Thomson	631-271-0028

GENERAL RULES

1. This Standard Flower Show conforms to the standards established by National Garden Clubs, Inc. (NGC). The *Handbook for Flower Shows* (HB), Revised 2017 Edition, with subsequent revisions printed in *The National Gardener* magazine (TNG), is the authority for all issues not covered by the Schedule, which is the Law of the Show.

2. The entire show is open to all members of Second District (District).

3. Staging set-up is on Thursday, September 19TH from 9-12NOON.

4. Entries for all divisions will be accepted at the rear entrance of Brecknock Hall (See specific Division Rules for procedures.)

Thursday, September 19 TH 12PM-5PM All Divisions	Friday, September 20 TH 8AM-12PM Horticulture, Design, Botanical Arts, Sections A & B only
---	---

Parking is available at Brecknock Hall. There is a handicapped ramp in the front of the Hall by the parking lot.

5. Arrangements for obtaining portable components may be made individually with the Properties Chairman (Laura McLaughlin 631-666-0029) after June 15TH. Pictures of the space are available from Gail Berti (631-271-7383, chiara215@aol.com).

6. Exhibits must be removed on Saturday, September 21ST from Brecknock Hall between 4PM-5PM. If a member cannot come during those hours, that member must arrange for the exhibits to be removed.

7. Judging will begin promptly at 1:30PM on Friday, September 20TH.

8. For all Divisions, Advance Entries tags will be filled out by the Advance Entry Chairmen and placed in exhibit's location. Plant material cards (3"x5" index cards) for all divisions and Horticulture Entry tags are available from the Entries Chairman (Gail Berti 631-271-7383) or the General Chairman (Bernadette Pepin 631-333-2405) at the April 22ND and June 24TH District board meetings. Additional cards will be available on Thursday, September 19TH during entry hours. All cards must be filled out in advance in pencil. See specific division rules for procedures.

9. All exhibits must be initialed in the right hand corner of the entry tag by the Classification Chairmen before the exhibitor leaves the floor. The Classification Chairmen for each division check exhibits for conformity to the schedule prior to judging. Final determination for conformance is the judges' responsibility.

10. The General Chairman and the Classification Chairmen for each division are

DIVISION IV + BOTANICAL ARTS

PHOTOGRAPHY RULES

1. Advance entry registration is required for all Division IV Botanical Arts Photography, Section C, classes 1-3 by August 30TH.

Advance Entry, Classification, & Placement Chairman:

Hilde Peters: 631-765-1337; bernhil@optonline.net

Consultant:

Bobby Duryea: 631-325-3438, williamduryea@gmail.com

2. All General Rules apply. The Rules for Photography are printed in the HB, Chapter 10, pp.95-96.

3. The Scale of Points for Photography Exhibits is listed on p. 24. Botanical Arts Photography Award is listed on p. 6. NGC Non-Top Award is listed on p. 7. District awards and trophies are listed on p. 7.

4. All exhibits must relate to horticulture, gardening, design, or other NGC goals, objectives and/or initiatives. (See HB, p. 95.)

5. Images must be matted (mounted) on foam core; no frames allowed.

6. Professional printing and matting is permitted.

7. Exhibitors are encouraged to label photographed plant material preferably with current scientific designation (see HB, pp. 53-54) in pencil on index cards obtained from the Advance Entry (Hilde Peters 631-765-1337) or General Flower Show Chairman (Bernadette Pepin 631-333-2405). (See General Rules p. 2, #8.) Listing of animals and insects is also encouraged, if identifiable. Botanical nomenclature is encouraged. (Consult HB, pp. 53-54 for Botanical Nomenclature).

8. Photo may be enhanced by the exhibitor with cropping, filters, adjustments and/or dark room techniques. Images with extreme manipulation may be displayed in a specific class/es.

9. Judging panel of three (3) may consist of one (1) NGC Accredited Judge and two (2) recognized photography experts, such as, qualified photography judges, photography instructors, photography professionals, or museum curators; or three (3) recognized photography experts.

10. Not eligible for exhibiting credit for judges.

11. Photography exhibits should come ready for placement on Thursday, September 19TH. **No exhibits will be accepted on Friday.** Hangers will be provided by the Committee and available at time of entry from Advance Entry Chairman.

DIVISION IV + BOTANICAL ARTS

SECTIONS AND CLASSES

“BELLS & WHISTLES”

SECTION B. ARTISTIC CRAFTS

“GO FOR BAROQUE”

Eligible for Botanical Arts Artistic Crafts Award

Advance entry required. Four entries in each class.

Class 1. “Head Turners”

A decorated Fascinator, staged on the center portion of a white cloth covered table 29”H upon a padded arm of a hat stand 6.5”H with four extended arms of different heights, supplied by committee. Arm heights are 12”H, 18”H, 24”H and 30”H. Fascinator hat form to be supplied by committee. Hat pin to be supplied by exhibitor. Total space allotted 15”W, height unlimited; hat elements may extend below form to a maximum length of 10”. Placement will be determined at time of advance entry.

Class 2. “Metallica”

A decorated Necklace staged on a black velvet neck form 7”W, 9”H, neck opening 3” diameter supplied by committee. Designs are displayed on a portion of a white cloth covered table 29”H.

Class 3. “Save the Date”

A decorated Invitation to the ball, mounted on foam board and staged on an iron easel 9”W, 12.5”H supplied by committee. Foam board is to be supplied by exhibitor. Designs are displayed on a portion of a white, cloth covered table 29”H. Total allotted space not to exceed 14” square.

available during judging for possible consultations. They, along with the judges and clerks, are the only personnel allowed on the floor during judging.

11. The decisions of the judges are final. Awards may be withheld if not merited.
12. There must be an emphasis on FRESH plant material. No artificial plant material is permitted in any exhibit in any division.
13. Each exhibitor is limited to one entry per class, except in the Horticulture Division and the Botanical Arts Horticulture Section.
14. The Flower Show Committee will strive to assure the safety of all items after arrival and placement, but is not responsible for any loss or damage to exhibits.
15. The use of plant material on the New York State and Second District Protected Native Plants Lists cannot be exhibited in competitive classes except in Division III, Education, Section A, class 1, exhibits 1-3 as an Educational Exhibit. Such plants must have been acquired in a lawful manner and may be cut specimens and/or potted plants. Commercially developed hybrids or cultivars (not natural varieties) of plants on the NYS and Second District lists are permitted in competitive classes, but only when the distinguishing feature is evident. The hybrid or cultivar must be named on the entry card. NYS and Second District Native Plants Lists are posted on fgcnys.com and district2fgcnys.com.
16. Awards will be presented by the Director at Brecknock Hall at 3:45PM on Saturday, September 21ST.

NATIONAL GARDEN CLUBS, INC. STANDARD SYSTEM OF AWARDS

**The NGC Standard System of Awards is used in all divisions.
(See HB, Chapter 5, pp. 39-48.)**

- Only one (1) first place (blue) ribbon per class or sub-class;
must score 90 points or more.
- Only one (1) second place (red) ribbon per class or sub-class;
must score 85 points or more.
- Only one (1) third place (yellow) ribbon per class or sub-class;
must score 80 points or more.
- One (1) or more Honorable Mention (white) ribbons as merited;
must score 75 points or more.

AWARDS
NGC, INC. TOP EXHIBITOR AWARDS

DESIGN DIVISION
TOP EXHIBITOR AWARDS

+**Award of Design Excellence.** The Award of Design Excellence is offered to the highest scoring blue ribbon winner and correctly named exhibit in the entire Design Division entered by an individual, scoring 95 points or more. It is a rosette of gold ribbons. There is a minimum of five (5) classes with four (4) exhibits per class, totaling at least twenty (20) exhibits in all. One (1) award is offered. Division I, Sections A-C, classes 1-9 are eligible.

DESIGN SECTION AWARDS

+**Designer's Choice Award.** The Designer's Choice Award is offered to the highest scoring blue ribbon exhibit, scoring 95 points or more, entered by an individual and provided all section requirements are met. It is a rosette of purple ribbons. Plant material may be dried, treated dried, and/or fresh. Exhibitor has complete freedom to choose other components within NGC policies. One (1) award is offered. Division I, Section B, classes 4-6 are eligible.

+**Table Artistry Award.** The Table Artistry Award is offered to the highest scoring blue ribbon exhibit, scoring 95 points or more, entered by an individual and provided all section requirements are met. It is a rosette of burgundy ribbons. Award is available for Functional and Exhibition Tables. One (1) award is offered. Division I, Section A, classes 1-3 are eligible.

+**Tricolor Award.** The Tricolor Award is offered to the highest scoring blue ribbon exhibit, scoring 95 points or more, entered by an individual and provided all section requirements are met. It is a rosette of red, blue, and yellow ribbons. Plant material must be fresh. Non-plant material may be included. One (1) award is offered. Division I, Section C, classes 7-9 are eligible.

DIVISION IV + BOTANICAL ARTS
ARTISTIC CRAFTS RULES

1. Advance entry registration is required for all Division IV Botanical Arts Artistic Crafts Exhibits, Section A, classes 1-3 by August 30th.
Advance Entry, Classification, Consultant & Placement Chairman:
Jenny Holmes 631-549-3635; zzjbear@verizon.net.
2. All General Rules apply. See p.2, #5 for obtaining staging components.
3. Judged by Artistic Crafts Scale of Points listed below. Botanical Arts Artistic Crafts Award is listed on p. 6. NGC Non-Top Award is listed on p. 7. District awards and trophies are listed on p. 7. The Rules for Artistic Crafts are printed in HB, chapter 10, pp. 94-95.
4. All Artistic Crafts must contain some fresh and/or dried plant material. Only dried material may be treated.
5. No artificial or endangered plant material may be used. (See General Rules p. 3, #15 regarding NYS and Second District Protected Native Plants.)
6. The exhibit must be the work of one (1) individual.
7. A card listing plant material must be included with all artistic crafts. Correct names of plant materials are to be listed in pencil. Cards can be obtained from the Advance Entries (Jenny Holmes 631-549-3635) or General Flower Show Chairman (Bernadette Pepin 631-333-2405). Botanical nomenclature is encouraged. (See HB, pp. 53-54).
8. No access to electricity.
9. All entries will be accepted in the rear entrance of Brecknock Hall. Artistic Crafts exhibits should come ready for placement. No designing space nor iron will be available for designers. Exhibits should be placed on Thursday, September 19th, if possible.

ARTISTIC CRAFTS SCALE OF POINTS

Criteria	Value (points)
Conformance	25
Design	30
Craftsmanship/Technique	25
Distinction	20
Total Score	100

DIVISION IV + BOTANICAL ARTS

SECTIONS AND CLASSES

“BELLS & WHISTLES”

SECTION A. BOTANICAL DESIGN

“IT’S ALL IN THE DETAILS”

Eligible for Botanical Arts Design Award

Advance entry required. Four entries in each class.

Class 1. “Love Letters”

A Collage Design, reminiscent of a Sailor’s Valentine, on a wooden plaque 10” square and staged on an iron easel. Wooden plaque and easel supplied by committee. Designs displayed on portion of a white cloth covered table 29”H in front of a wallpapered wall. Space allotted 16”L, 30”D.

Class 2. “Over the Top”

A Topiary Design, staged on a portion of a mantle 47”H. Total allotted space 6.5”W, 9.5”D, unlimited height. There will be two designs on a mantle. Mantle one, of pink marble, will be in the dining room against a wallpapered wall. Mantle two, of white and grey marble, will be in the study against a gold wall with a portrait painting over it. Mantle placement will be determined at time of advance entry.

Class 3. “Mixed Emotions”

A Pot-et-Fleur Design, staged on a black pedestal 15”square, 42”H. Two designs will be placed in front of a window with cream trim and a tapered curtain half way and two designs will be placed against a wallpapered wall. Total allotted space 30”W, 15”D, height unlimited. Underlay permitted with maximum overhang of 10”. Placement will be determined at time of advance entry.

HORTICULTURE DIVISION TOP EXHIBITOR AWARDS

†**Award of Horticultural Excellence.** The Award of Horticulture Excellence is offered to the highest scoring blue ribbon winner scoring 95 or above and correctly named exhibit in the entire Horticulture Division entered by an individual. It is a rosette of green, orange and blue ribbons. There is a minimum of five (5) classes and a minimum of twenty (20) exhibits in all. One (1) award is offered. Division II, Sections A-H, classes 1-28 are eligible.

HORTICULTURE SECTION AWARDS

†**Award of Merit.** The Award of Merit is offered to the highest scoring blue ribbon exhibit, scoring 95 points or more, for all cut, non-woody specimens, including vines, entered by an individual and provided all section requirements are met. It is a rosette of orange ribbons. Four (4) awards are offered. Division II, Sections A-D, classes 1-16 are eligible.

†**Club Competition Award.** The Club Competition Award is offered to the highest scoring blue ribbon exhibit, scoring 95 points or more, for all displays entered by more than one member from each club and provided all section requirements are met. It is a rosette of light blue ribbons. There is a minimum of four (4) exhibits in one (1) class. One (1) award is offered. Division II, Section H, class 28 is eligible.

†**Grower’s Choice Award.** The Grower’s Choice Award is offered to the highest scoring blue ribbon exhibit, scoring 95 points or more, for all container-grown plants (single, multiple, self-multiple, and combination plantings) entered by an individual and provided all section requirements are met. It is a rosette of dark green ribbons. Three (3) awards are offered. Division II, Sections E-G, classes 17-27 are eligible.

DIVISION IV + BOTANICAL ARTS

BOTANICAL DESIGN RULES

EDUCATION DIVISION TOP EXHIBITOR AWARD

+**Educational Top Exhibitor Award.** The Educational Top Exhibitor Award is offered to the highest scoring blue ribbon winner and correctly named exhibit in the entire Education Division entered by an individual or an organization and provided all division requirements are met. It is a rosette of brown and white ribbons. A minimum of two (2) educational exhibits designated as eligible must be present. One (1) award is offered. Division III, Section A, class 1, exhibits 1-3 are eligible.

BOTANICAL ARTS DIVISION TOP EXHIBITOR SECTION AWARDS

+**Botanical Arts Artistic Crafts Award.** The Botanical Arts Artistic Crafts Award is offered to the highest scoring blue ribbon winner, scoring 95 points or more, entered by an individual and provided all section requirements are met. It is a rosette of navy blue ribbons. There is a minimum of (3) classes and four (4) exhibits per class. One (1) award is offered. Division IV, Section B, classes 1-3 are eligible.

+**Botanical Arts Design Award.** The Botanical Arts Design Award is offered to the highest scoring blue ribbon winner, scoring 95 points or more, entered by an individual and provided all section requirements are met. It is a rosette of yellow and orange ribbons. There is a minimum of (3) classes and four (4) exhibits per class. One (1) award is offered. Division IV, Section A, classes 1-3 are eligible.

+**Botanical Arts Photography Award.** The Botanical Arts Photography Award is offered to the highest scoring blue ribbon winner, scoring 95 points or more, entered by an individual and provided all section requirements are met. It is a rosette of black and white ribbons. Photographs must relate to NGC goals and objectives. There is a minimum of (3) classes and four (4) exhibits per class. One (1) award is offered. Division IV, Section C, classes 1-3 are eligible.

1. Advance entry registration is required for all Division IV Botanical Arts, Botanical Design Exhibits, Section A, classes 1-3 by August 30TH.

Advance Entry Classification, Consultant & Placement Chairman:
Sue Boudreau 631-666-9517; sueboudreau@optonline.net.

2. All General Rules apply. See p 2, #5 for obtaining staging components. General guidelines for Botanical Design apply (HB, Chapter 3, pp.28-29). The General Guidelines for all Designs apply as printed in HB, chapter 10, pp. 93-94, including a card listing plant material used in the design.

3. Judged by Design Scale of Points p. 9. Botanical Arts Design Award is listed on p. 6. NGC Non-Top Award is listed on p. 7. District awards and trophies are listed on p. 7.

4. All exhibits must contain some plant material. (See HB pp. 93-94 regarding specific design rules for "fresh and/or dried" plant material.)

5. No artificial or endangered plant material may be used. (See General Rules p. 3, #15 regarding NYS and Second District Protected Native Plants.)

6. The exhibit must be the work of one (1) individual.

7. A card listing plant material must be included with all Botanical Designs. Correct names of plant materials are to be listed in pencil. Cards can be obtained from the Advance Entries (Sue Boudreau 631-666-9517) or General Flower Show Chairman (Bernadette Pepin 631-333-2405). Botanical nomenclature is encouraged. (See HB, pp. 53-54).

8. All entries will be accepted in the rear entrance of Brecknock Hall. Botanical Design exhibits should come ready for placement. No designing space nor iron will be available for designers. Exhibits should be placed on Thursday, September 19TH, if possible.

9. Room appointments for the section include: wallpaper of a pink, blue and cream in traditional pattern with cream trim; a cream colored chair rail; a floral patterned rug of mauve, blue, and cream; taupe drapery, a large gold leafed mirror; and a pink marble fireplace.

EDUCATIONAL EXHIBITS SCALE OF POINTS

Criteria	Value (points)
Educational Value	
Interest to viewer	25
Clear, concise presentation	15
Adequate signage	10
Conforms to NGC objectives	10
Staging	
Craftsmanship, Technique	10
Distinction	10
Creativity and Expression	<u>20</u>
Total Score	100

DIVISION III + EDUCATION

SECTION AND EXHIBITS

“CULTURAL CONVERSATIONS”

Eligible for Educational Top Exhibitor Award

Advance entry required. Exhibits to be staged incorporating a black, trifold presentation board 48”H, 36”W, on a white cloth covered table 29”H. Table covering supplied by the Committee. Presentation board supplied by exhibitor. Total space allotted 72”L, 30”W, height unlimited.

SECTION A. EDUCATIONAL EXHIBITS

“NATURE SPEAKS VOLUMES”

Class 1.

Exhibit 1. “Scent with Love”

Lavender farms on the North Fork bring great crowds of tourists to view acres of flowering spikes and enjoy the lovely scent. This herb is a perennial favorite for attracting pollinators in the landscape and for its highly versatile essential oils.

Exhibit 2. “Viticulture”

Viticulture, the science, production, and study of grapes, has resulted in a local business that has made an enormous impact on the economy of the East End of Long Island.

Exhibit 3. “Osprey”

The Osprey also called sea hawk, river hawk and fish hawk is a beloved resident on Long Island, one of two main breeding areas in New York. Their distinctive nests along the shoreline attract interest to this once endangered species.

NATIONAL GARDEN CLUBS, INC. NON TOP EXHIBITOR AWARDS

+ **Sweepstakes Award.** The Sweepstakes Award is offered to the member with the highest number of points in Horticulture, Design, and Botanical Arts Divisions and Overall Flower Show. Award is determined by the Awards Committee using the Scale of Points (listed below). Awards are presented at the Awards presentation (See General Rules #16, p. 3). It is a rosette of green and white ribbons. Four (4) awards are offered. Divisions I, II and IV are each eligible for Sweepstakes Awards. Divisions I-IV are eligible for Overall Flower Show Sweepstakes Award.

NON-TOP AWARDS & DISTRICT TROPHIES SCALE OF POINTS

NGC Top Award	5 Points
First Place	4 Points
Second Place	3 Points
Third Place	2 Points
Honorable Mention	1 Point

SECOND DISTRICT AWARDS & ROTATED TROPHIES

+ **Second District Design Trophy** May be awarded to the club with the highest point total in the Design Division. Sections A-C, classes 1-9 are eligible.

+ **Second District Horticulture Trophy** May be awarded to the club with the highest point total in the Horticulture Division. Sections A-G, classes 1-27 are eligible.

+ **Second District Challenge Trophy** May be awarded to the club with a blue winning exhibit scoring 95 or above in the Horticulture Division for a Display. Section H, class 28 is eligible.

+ **Jeanne Beryl Metz Trophy** May be awarded to the individual who wins the Design Excellence Award. Sections A-C, classes 1-9 are eligible.

+ **Joan Corbisiero Trophy** May be awarded to the individual who wins the Horticulture Excellence Award. Sections A-G, classes 1-27 are eligible.

+ **Beryl Woods Trophy** May be awarded to the individual with the highest point total in the Botanical Arts Division. All classes in Sections A-C are eligible.

DIVISION I + DESIGN RULES

1. All General Rules apply. See p. 2, #5 for obtaining staging components.
2. The NGC Exhibit Policies are printed in HB, Chapter 7, Section X, pp. 79-80, Exhibiting in the Design Division, NGC Policies and Guidelines.
3. Advance entry registration is required for Design Division I, Sections A-C, classes 1-9 by August 30th. Pictures of design spaces are available through Consultant.
Advance Entry, Classification, Consultant & Placement Chairman:
Gail Berti 631-271-7383; chiara215@aol.com
4. NGC Top Exhibitor Design Awards and Sections eligible are listed on p. 4. NGC Non-Top Awards are listed on p. 7. District awards and trophies are listed on p. 7. The Scale of Points for Design is listed on p. 9.
5. Plant material and non-plant material permitted and not permitted in the Design Division are printed in HB, Chapter 7, Section X, pp. 80-81.
6. Some plant material, either fresh and/or dried, is required in all Design exhibits, except for Design Section C which must be of all fresh plant material. Fresh plant material need not have been grown by Exhibitor. Fresh plant material may not ever be treated in any manner.
7. All plant material used in the design must be identified in pencil on an index card obtained from the Advance Entry (Gail Berti 631-271-7383) or General Flower Show Chairman (Bernadette Pepin 631-333-2405) and included with the entry tag. Botanical nomenclature is encouraged (Consult HB, pp. 53-54).
8. The exhibitor is required to conform to the stated descriptions and limitations of the Design Type, if named in the class.
9. Rules for Design Types, Advanced Design Types, Table Designs and Table Appointments are printed in HB, Chapter 7, pp. 69-79.
10. Designer is on her/his honor that the design being entered has not been previously entered or judged in an NGC Standard Flower Show.
11. If designer is unable to fulfill her/his assignment, it is the designer's responsibility to find a replacement.
12. Entries will be accepted in Brecknock Hall via the rear entrance. Designs should come ready for placement. No designing space nor iron will be available for designers. Staging and non-floral components should be placed on Thursday, September 19th, if possible.

DIVISION III + EDUCATION

EDUCATION RULES

1. All General Rules apply.
2. Education exhibits may be the work of more than one individual or organization unless a Student Judge or an Accredited Judge is seeking exhibiting credit for preparing an education exhibit.
3. Advance entry registration is required for all Division III Education, Section A class 1, exhibits 1-3 by August 30th.
Advance Entry, Classification, Consultant & Placement Chairman:
Lovejoy Duryea 917-734-9595, lovejoy.duryea@gmail.com
4. An exhibit must occupy a minimum of eighteen (18) square feet of surface area.
5. All exhibits are competitive. NGC Educational Top Exhibitor Award is listed on p. 6. Non-Top Awards are listed on p. 7. District Awards and Trophies are listed on p. 7. The Scale of Points for Educational Exhibits is listed on p. 18.
6. Some plant material is required. (See General Rules p. 3, #15 regarding NYS and Second District Protected Native Plants.) No artificial plant material is permitted.
7. Correct names of plant materials are to be listed in pencil on index cards obtained from the Advance Entry (Lovejoy Duryea 917-734-9595) or General Flower Show Chairman (Bernadette Pepin 631-333-2405). Botanical nomenclature is encouraged (Consult HB, pp. 53-54).
8. No access to electricity.
9. Entries will be accepted in the rear entrance of Brecknock Hall. Educational exhibits should come ready for placement. No designing space nor iron will be available for designers. Staging, exhibit, and non-floral components must be placed on Thursday, September 19th, see General Rules for times.

Class 21. Rhizomatous (Rex)

Class 22. Tuberous (Reiger)

SECTION G. "THE ELIGIBLE BACHELORS"

Container Grown Plants, Foliage

Eligible for Grower's Choice Award. One specimen (single, multiple, self-multiple). See Horticulture Rules for container requirements.

Class 23. Cacti

Class 24. Succulents

Class 25. *Plectranthus scutellarioides* (Coleus)

Class 26. *Pelargonium* (scented geraniums)

Class 27. Any other worthy container grown plant, foliage.

SECTION H. "THE DRESS OFFICERS"

Displays

Eligible for Club Competition Award. Advance Registration required. A minimum of seven (7) specimens grown by two (2) or more club members. See Horticulture Rules for container requirements. Four entries in each class. Displays staged in front of a cream-colored wall on a portion of a white cloth covered table 29"H. Table covering supplied by the Committee. Total allotted space 30"L, 30"D, height unlimited.

Class 28. Cut Perennials and Annuals, flowering and/or foliage

DESIGN SCALE OF POINTS	
Criteria	Value (points)
Conformance	
To Type	7
To Schedule Requirements	7
Design Principles	48
Selection of Components	8
Organization of Components	8
Expression	8
Distinction	14
Total Score	100

DIVISION I + DESIGN SECTIONS AND CLASSES "HAVING A BALL"

Eligible for Award of Design Excellence

The Designer has the freedom to choose traditional or creative style with any design listed unless restricted by the schedule. Four entries in each class.

Room appointments for the division include: blush beige colored walls with cream trim, taupe drapery, large gold leafed mirrors and white and grey marble fireplaces.

SECTION A.

"FABULOUS FETES"

Eligible for Table Artistry Award.

Class 1. "The Captain Dines Alone"

An Informal, Alfresco, Functional Table for one staged in front of a blush beige colored wall on black pedestal with a 24" round top, 29"H. Underlay required.

Class 2. "Standing Room Only"

A Semiformal, Functional Cocktail Table for two, staged on a free standing bistro table 24" round, 30.5"H. Underlay required.

Class 3. "A Rock Star Dinner"

An Informal, Exhibition Table staged in front of a blush beige colored wall on a portion of a white cloth covered table 29"H. Table covering supplied by Committee. Total allotted space 30"L, 30"W, height unlimited.

SECTION B.

“DANCING IN TIME”

Eligible for Designer’s Choice Award.

Class 4. “The Twist”

A Floor Design staged in a window nook 46”W, 15”D. Total allotted space 46”W, 15”D with a tapered curtain half way, height unlimited.

Class 5. “Jitterbug”

An Angular Design staged in front of a cream-colored wall on a portion of a white cloth covered table 29”H. Table covering supplied by the Committee. Total allotted space 30”L, 30”D, height unlimited.

Class 6. “The Continental”

A Cascade Design staged in front of a cream-colored wall on a white pedestal 16”square, 42”H. Total allotted space 18”square, height unlimited. Design may extend below pedestal top.

SECTION C.

“THE CONGENIAL HOSTS”

Eligible for Tricolor Award. Plant material must be all fresh.

Class 7. “The Shipping Magnate”

A Duo Design staged on a pedestal 24”round, 42.5”H. Underlay permitted with no overhang. Total allotted space 24”diameter, height unlimited.

Class 8. “The Mistress of the Mansion”

A Duo Design staged on a pedestal 24”round, 42.5”H. Underlay permitted with no overhang. Total allotted space 24”diameter, height unlimited.

Class 9. “The Growing Family”

A Vertical Line Mass Design staged on a portion of a mantle 47”H in front of a large, triptych mirror with a gilded frame. There will be two designs on each of the two identical mantles. Total allotted space 6.5”L, 8”D, height unlimited.

SECTION D. “THE GENTLEMEN FARMERS”

Vegetables, Fruits or Nuts

Eligible for Award of Merit. One cut specimen, unless otherwise specified. Shown at peak maturity for consumption or use.

Class 13. *Capsicum*

- a. Large, one pepper, one-half inch stem attached, stem side up for bells, all others on their sides
- b. Small, 3 peppers, one-fourth inch stem attached, stem side up for bells, all others on their sides

Class 14. *Cucurbita*

- a. Gourds, stem attached
- b. Summer squash, stem attached
- c. Winter squash, stem attached

Class 15. *Solanum lycopersicum*

- a. Large, one tomato, stem side up, no stem
- b. Small, 5 tomatoes or more, stem attached

Class 16. Any other worthy vegetable, fruit, or nut

SECTION E. “THE MEN ABOUT TOWN”

Combination Plantings

Eligible for Grower’s Choice Award. Advance entry required. Combination Plantings are of three (3) or more botanically different plants with similar cultural requirements, flowering and/ or foliage. (See HB, p. 59) Four entries in each class.

Class 17. Planters, in a white urn 16” diameter and tapered down 12” deep, 19”H, supplied by the committee, must be double potted.

Class 18. Planters, to be hung from shepherd’s hooks. Pot not to exceed 14” diameter. Hooks supplied by the committee.

Class 19. Dish Gardens, not to exceed 14” in any direction.

SECTION F. “THE RAVING BEAUTIES”

Container Grown Plants, *Begonias*

Eligible for Grower’s Choice Award. One specimen (single, multiple, self-multiple). See Horticulture Rules for container requirements.

Class 20. Fibrous

DIVISION II + HORTICULTURE SECTIONS AND CLASSES “THE GUEST LIST”

Eligible for Award of Horticultural Excellence

Consult Horticulture Policy on Length of Possession HB, p. 55.

SECTION A. “THE DEBUTANTES”

Cut Specimens, Flowering Annuals

Eligible for Award of Merit. One cut stem.

Class 1. *Celosia*

Class 2. *Tagetes* (Marigold), single bloom, no side shoots, three leaves

Class 3. *Zinnia*, single bloom, no side shoots, two sets of leaves, small- one set

Class 4. Any other worthy flowering annual

SECTION B. “THE DOWAGERS”

Cut Specimens, Flowering Perennials

Eligible for Award of Merit. One cut stem.

Class 5. *Anemone*

Class 6. *Rosa*, two sets of five-leaflet leaves

a. single bloom, disbudded

b. spray, at least three open blooms, several buds in various stages of development

Class 7. *Sedum*

Class 8. Any other worthy flowering perennial

SECTION C. “THE BELLES OF THE BALL”

Cut Specimens, Flowering + *Dahlias*

Eligible for Award of Merit. One cut stem, disbudded, one set of leaves.

Class 9. Giant, 10” and over

Class 10. Large, over 6”-9”

Class 11. Small, 4”- 6”

Class 12. Miniature, under 4”

DIVISION II + HORTICULTURE RULES

1. All General Rules apply. See p. 2, #5 for obtaining staging components.
2. Advance entry registration is required for Horticulture Division II, Section E, classes 17-19 and Section H, class 28 and by August 30TH.

Advance Entry Chairman:

Denise D’Onofrio -Zizzo 631-757-3710; denisezizzo@optimum.net

3. The NGC Exhibit Policies are printed in HB, Chapter 6, Exhibiting in the Horticulture Division, p. 55. All exhibits must be FRESH and grown by the exhibitor. (Consult Horticulture Policy on Length of Possession HB, p. 55.)
4. The rules for a single species cut or container-grown specimens are listed in HB, Chapter 6, pp. 58-61 or its supplement *Horticulture Exhibiting and Judging*.
5. NGC Top Exhibitor Horticulture Awards and sections eligible are listed on p. 5. NGC Non-Top Awards are listed on p. 7. The Scales of Points for Horticulture are listed on pp. 12-13. District Awards and Trophies are listed on p. 7.
6. In order to receive an NGC Top Exhibitor Award, the exhibitor must identify her/his entry by its binomial name or currently acceptable scientific designation. (Consult HB, Exhibiting in the Horticulture Division, Chapter 6, pp. 53-54.) Common names in parentheses may be included.
7. Horticulture Consultants:
Denise D’Onofrio -Zizzo 631-757-3710 and Kim Thomson: 631-271-0028.
8. Entry Cards are to be filled out in advance, if possible. Entry cards must be written and filled out in pencil; address labels are acceptable where appropriate. Entry cards and plant material cards can be obtained from the Entry Chairman (Gail Berti 631-271-7383) and General Flower Show Chairman (Bernadette Pepin 631-333-2405). (See also General Rules p. 2, #8.) (See HB, Chapter 6, p. 57 for a correctly filled out entry tag.)
9. Cut specimens should not have foliage below the water line, except for *Gladiolus*. Only foliage attached to a stem of a specimen may be included in the exhibit.
10. If a plant is considered a flowering plant, it should be exhibited as a flowering specimen. Foliage plants may flower, but should be exhibited as a foliage plant if they are grown for their leaves.
11. Specimens with a class designation in the schedule may not be entered in the “Any Other Worthy Specimen” class.

12. Plant material on the NYS Protected and Second District Native Plant Lists is prohibited. (See General Rules, p. 3, #15.)

13. The Horticulture Classification Chairmen and /or General Show Chairman are free to subdivide classes by color, form, size, cultivar, variety, or other distinguishing characteristic.

14. Cut specimens must be exhibited in clean, colorless, clear glass containers supplied by the exhibitor. Cut specimens for Section D, classes 13-16 are to be exhibited on white paper plates, supplied by committee. An unstable exhibit may be disqualified by Classification. (Consult HB, p. 56, B, 4 for weighting.)

15. For Container-grown plants, container size is determined by the inside diameter/length of the container. See specific class for container sizes for Section E. Maximum container size for Sections F and G is 6" Diameter. Containers for Sections F and G should be saucered or double potted. (Consult HB, p. 56 for specimen staging.)

16. Wedging of wood, cork or plastic wrap is permitted and supplied by the exhibitor. Wedging may be visible, but must not detract from the cut specimen.

17. Entries will be accepted in the rear entrance of Brecknock Hall. Please enter by the stairs to the restrooms. Entry table will be on your right in the Great Hall. Sturdy Horticulture specimens and Container-grown plants should be entered on Thursday, September 19TH. Water is available by outdoor spigot near rear entrance.

HORTICULTURE SCALE OF POINTS	
I. ALL CUT OR CONTAINER-GROWN HORTICULTURE SPECIMENS AND COLLECTIONS	
(Arboreal, Flowering, Foliage, Fruit/Vegetable/Nuts)	
Criteria	Value (points)
Conformance	5
Plant Identification	5
Peak of Perfection	
Form	20
Color	20
Maturity/ Size	20
Condition/ Blemishes	15
Grooming/ Staging	
Grooming	10
Staging	5
Total Score	100

HORTICULTURE SCALE OF POINTS	
II. COMBINATION PLANTINGS AND GARDENS	
Criteria	Value (points)
Conformance	5
Plant Identification	5
Labeling	5
Peak of Perfection	
Form	10
Color	10
Condition	10
Show-worthy Size	5
Overall Effect	30
Creative/ Distinctive	5
Grooming	10
Staging	5
Total Score	100

HORTICULTURE SCALE OF POINTS	
III. DISPLAYS	
Criteria	Value (points)
Conformance	5
Plant Identification	5
Labeling	5
Grooming	5
Peak of Perfection	
Form	10
Color	10
Maturity/Size	10
Condition	10
Design Principles	30
Creative/ Distinctive	10
Total Score	100